

# Window Hardware



**SASH + DOOR  
HARDWARE**

## What's inside

- Espag Window Locks
- Excalibur Shootbolt System
- Friction Hinges
- Trickle Vents
- Window Furniture



From our blog.

# WHY MANUFACTURE FRENCH CASEMENT WINDOWS WITH A FLYING MULLION?

Read the full article  
on pages 08-09

SIGN UP FOR A **TRADE LOGIN** ONLINE TO VIEW TRADE PRICES AND ADDED BENEFITS



[www.sdhardware.co.uk](http://www.sdhardware.co.uk)

REVIEWS.io



4.8 / 5.0

We're rated excellent  
on **reviews.io**

## TRADE DISCOUNTS.

Don't forget you are receiving a **TRADE ONLY** discount on all products. You can send your customers to our website to choose products knowing they won't see your discounted prices. This is particularly helpful for window and door furniture and can earn you some extra income in marking up to our online retail prices.



# CONTENTS.

Espag Window Locks	05 - 07
Excalibur Shootbolt System	10 - 11
Friction Hinges	12 - 15
Window Accessories	16
Trickle Vents	17 - 19
Window Furniture	20 - 31

**Featured range**  
Titon Trickle Vents on pages 17-19



Secure payments powered by **worldpay** MOST MAJOR CREDIT CARDS ACCEPTED



**FREE UK CARRIAGE ON ORDERS OVER £120**  
(EXCLUDING SASH WEIGHTS)

CARRIAGE CHARGES MAY ALSO APPLY TO DIRECT DELIVERIES

SDH reserve the right to change the design and specification of any item herein without notice. All measurements are in millimetres unless otherwise stated. All prices are subject to VAT. E&OE.

# Anatomy of a Casement Window

and what **SDH** can supply

- 1. Espagnolette Bolts
- 2. Friction Hinges

- 3. Accessories and Security
- 4. Trickle Vents

- 5. Furniture

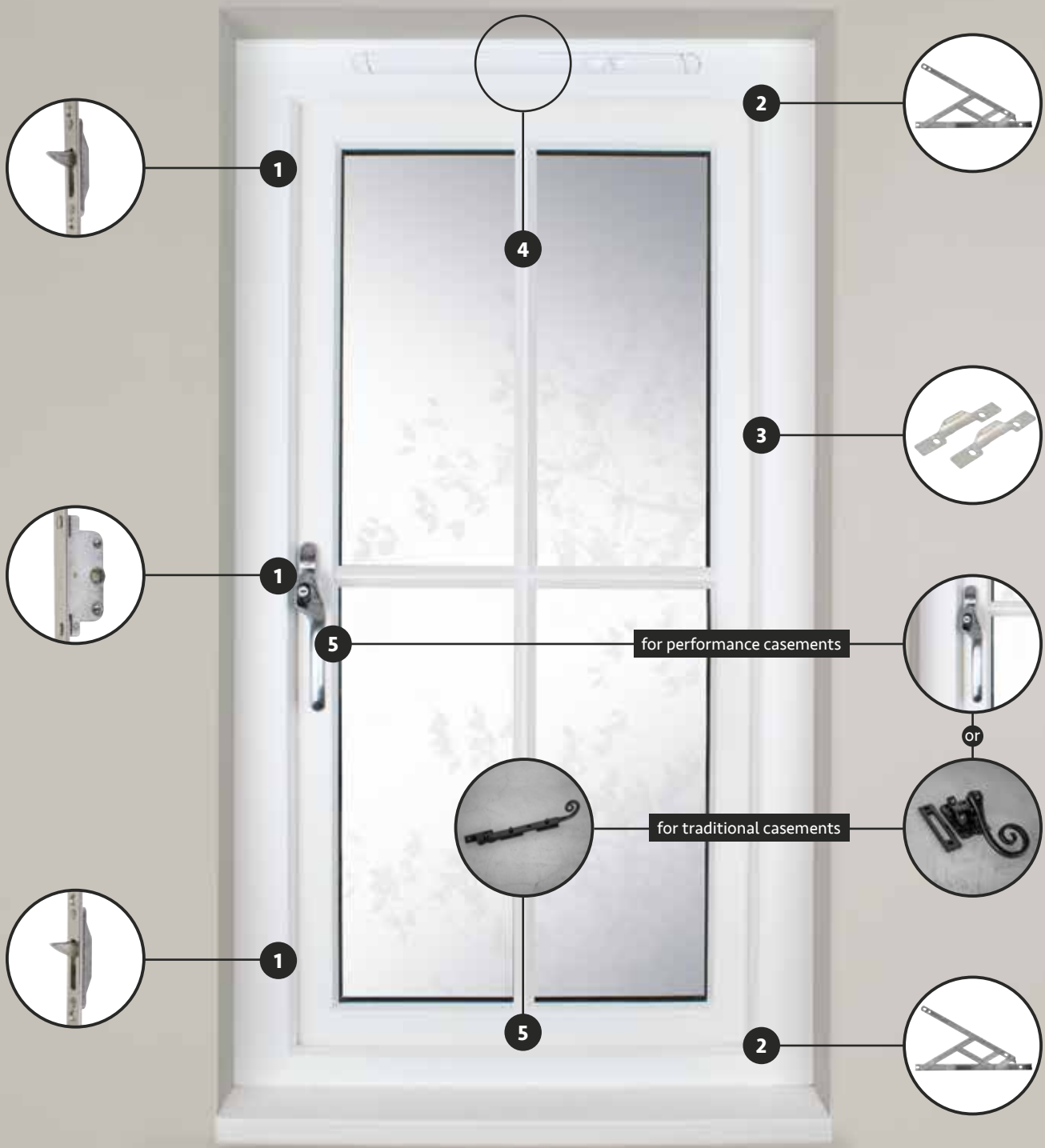

We have all bases covered at **SDH** when you're looking for the products needed to manufacture a casement window.

Please get in touch and we'll be happy to help with your next window project.

### Flush Tongue Retractable Espagnolette



This retractable tongue espag is more comprehensive and secure than other products currently on the market. With its greater range of sizes, a more positive gearbox, 17mm solid die-cast tongues, and a corrosion-resistant finish. This product has been designed to cater to the traditional square edge flush casement that requires a high-security locking system.

- 17mm solid high-security tongue
- Shallow Euro groove
- Positive gearbox

#### WHY USE?

- 25 or 30mm backset
- Single or nightvent keeps
- Supercoat 500 corrosion tested to 30,000 cycles

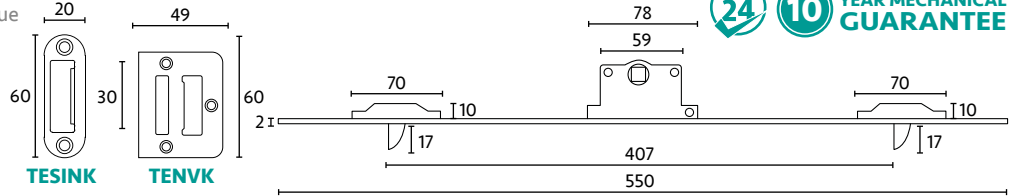

	350mm	540mm	740mm	940mm	1140mm	1340mm	TENVK	TESINK
25 or 30mm Backset	£5.18	£5.93	£6.46	£7.82	£9.05	£12.94	Tongue Espag Night Vent Keep	Tongue Espag Single Keep
Part Code	TE350BS30/25	TE550BS30/25	TE750BS30/25	TE950BS30/25	TE1150BS30/25	TE1340BS30/25		
Keeps required	2	2	2	3	4	4	67p	66p

### Stainless Steel Espag

The Securistyle Stainless Steel Espag Bolt has a robust bi-directional cam that is smooth to operate and easy to maintain.

- Extra pin to reinforce Mushroom for added security
- Corrosion resistance to 96 hours salt spray test
- BS 7950, BS EN 1670, Class 4 corrosion performance
- 22mm backset with 7.7mm mushroom
- Tested to PAS24
- 12 Year Guarantee
- 16mm faceplate

#### WHY USE?

- Proven brand and product
- Stainless steel so recommended to use with Accoya and in Coastal Areas

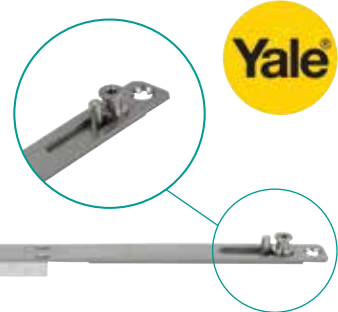

	280mm	370mm	500mm	630mm	760mm	890mm	1020mm	1150mm	MA94275
Price	£9.66	£9.97	£11.17	£12.12	£13.67	£15.63	£16.66	£17.22	Night Vent Keep
Part Code	YALST280	YALST370	YALST500	YALST630	YALST760	YALST890	YALST1020	YALST1150	
Keeps required	2	2	2	2	3	3	3	3	£1.05

### ERA Extreme Shootbolt Window Lock

A non-croppable shoot bolt locking system for casement windows designed to maximise window security with unique locking bolts and adjustable mushroom cams

- Up to 11 locking points for maximum security and perceived security gives visual added benefits
- Non-croppable - quick and easy to install locking solution
- Heavy-duty shootbolts for maximum security
- Proven and tested design
- Standard 62mm gearbox rout
- Smooth and positive locking for ease of use
- 12mm Faceplate
- 8mm Cams



#### WHY USE?

- PAS24 Tested
- Part Q Compliant



#### ERA Extreme Shootbolt Keep

- Handed

PQ-EXSK

£1.33 ex VAT



#### ERA Extreme Extensions

- Size 1-4

PQ-EESB

£5.93 ex VAT



SCAN FOR EXTENSION SIZE CHART



	PQ-EB230	PQ-EB400	PQ-EB600	PQ-EB800	PQ-EB1000	PQ-EB1200	PQ-EB1400
DESCRIPTION	Shootbolt Window Lock 230mm (22mm Backset)	Shootbolt Window Lock 400mm (22mm Backset)	Shootbolt Window Lock 600mm (22mm Backset)	Shootbolt Window Lock 800mm (22mm Backset)	Shootbolt Window Lock 1000mm (22mm Backset)	Shootbolt Window Lock 1200mm (22mm Backset)	Shootbolt Window Lock 1400mm (22mm Backset)
PRICE	£2.13	£2.69	£3.15	£3.82	£4.54	£5.18	£5.38

### Maco™ Rail Espag

- Bi-directional cams that lock either side of the keep, ensuring complete security
- Fully adjustable mushroom locking bolts
- 22mm Backset
- 7.7mm mushroom cam height

#### WHY USE?

- PAS24 Tested
- Highly secure product
- Adjustable cams



22 Backset  
7.7 Cam Height

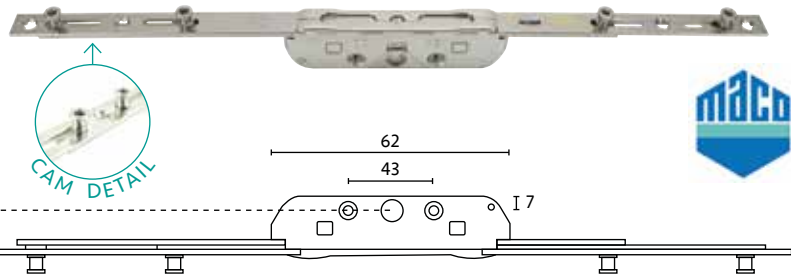

	MA202699	MA202700	MA202701	MA202702	MA202703	MA202704
LENGTH	200mm	400mm	600mm	800mm	1000mm	1200mm
KEEPS REQUIRED	2	2	2	3	3	3
PRICE	£7.12	£8.37	£9.70	£12.49	£12.97	£13.70

MA94275
Maco Mushroom Keep
£1.05

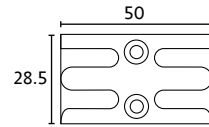

### Maco™ Inline Espag

- Fully adjustable
- 22mm Backset
- 7.7mm cam height
- 2 keeps required on 260, 400, 600 & 800mm espags
- 3 keeps required on 1000 & 1200mm espags

#### Maco™ Plastic Bevelled Packer

• To suit MA94275

MA356098

**43p**  
ex VAT



#### WHY USE?

- High quality adjustable cams
- Timber keeps with bevelled packer

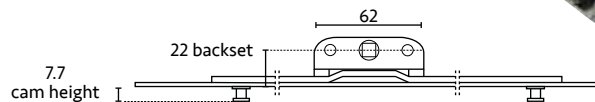

	MA58496	MA58504	MA58511	MA58518	MA58525	MA58530
LENGTH	260mm	400mm	600mm	800mm	1000mm	1200mm
KEEPS REQUIRED	2	2	2	2	3	3
PRICE	£5.31	£5.34	£6.09	£6.83	£7.77	£8.30

MA94275
Maco Mushroom Keep
£1.05

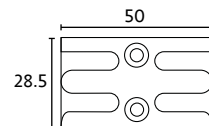

### Maco™ Mk1

The most comprehensive shoot bolt locking system in the Timber Window industry. A flexible system that can be used for French casement twin handle situations, please enquire with our sales team for more information.

- PAS24 Certificate available
- Offset handle feature
- 'V' shape shoot bolt return for extra stability



MA94310



MA94275

#### Maco™ Plastic Bevelled Packer

• To suit MA94275

MA356098

**43p**  
ex VAT



'V' SHAPE SHOOT BOLT



USE WITH FLYING MULLION

CROPPABLE

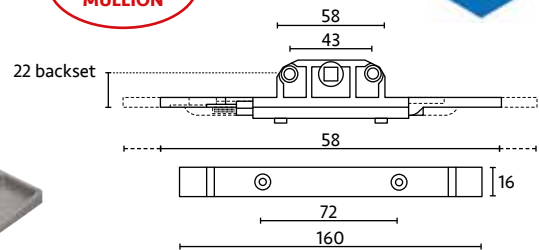

	MA11263	MA58177	MA58160	MA58162	MA58164	MA94275	MA94310
DESCRIPTION	22mm Lock Box	320-400mm ext, no mushroom*	401-800mm x 1 mushroom cam per ext*	801-1100mm ext x 2 mushroom cams per ext*	1101-1400mm ext x 2 mushroom cams per extension	Mushroom Strike (Quantity dependent on sash size)	Shootbolt Strike
PRICE	£4.61	£3.69	£4.08	£4.33	£4.47	£1.05	91p

**Vanguard Standard**

- 7.7mm CAM
- 22mm Backset
- Timber night vent keep with 2 fixing pins
- Salt spray tested to 96 hours
- 16mm euro groove
- Boxed in 10's

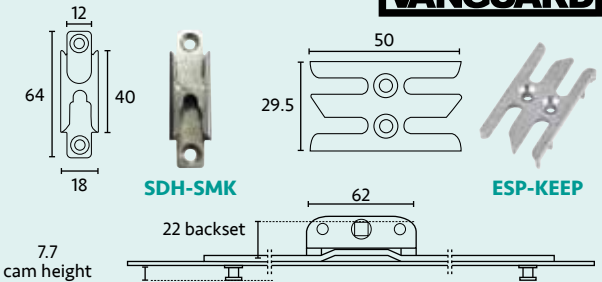

**WHY USE?**

- Extremely competitive
- Radius end for a great finish



	ESP240	ESP400	ESP600	ESP800	ESP1000	ESP1200
LENGTH	240mm	400mm	600mm	800mm	1000mm	1200mm
KEEPS REQUIRED	2	2	2	2	3	3
PRICE	£2.41	£2.86	£3.41	£4.13	£4.77	£5.37

SDH-SMK	ESP-KEEP
Single Mushroom Keep	Vanguard Timber Night Vent Keep
£1.01	53p

**Roto Twin Cam Espagnolette Bolt**

Roto hardware is coated as standard with the best-in-class NanoSil Level 6 surface protection. The micro crystalline structure is designed to provide protection to parts such as rivets and hinge components as well as flat surfaces. This market-leading coating copes with extreme fluctuations in temperature and humidity easily exceeding all current UK corrosion resistance criteria.

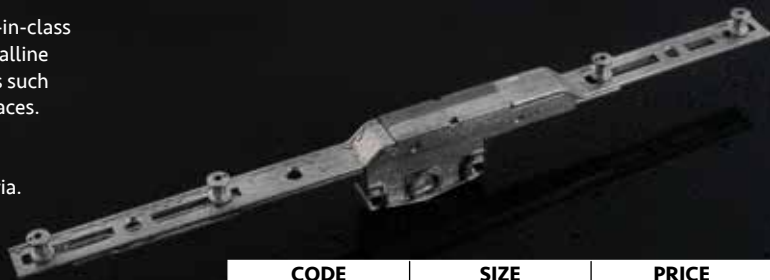

Roto hardware has been tested and approved for use with Accoya wood. So you can be assured these Roto espag bolts are the perfect solution for your Accoya windows.



CODE	SIZE	PRICE
ROT305-22-8	305mm	£5.75
ROT400-22-8	400mm	£6.06
ROT550-22-8	550mm	£6.78
ROT750-22-8	750mm	£8.08
ROT850-22-8	850mm	£8.43
ROT950-22-8	950mm	£8.74
ROT1050-22-8	1050mm	£9.11
ROT1150-22-8	1150mm	£9.72

**Maco Security Keep**

This keep has 3 fixing points that increases its security especially in PAS 24 testing

- 8mm high
- 3 fixing points
- 35 x 50 x 8mm

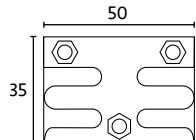

MA359381

£1.34 each



**Low Height Keep**

This keep has been designed for the industry where tolerances are tight

- 6mm height
- Night vent
- 28 x 52 x 6mm

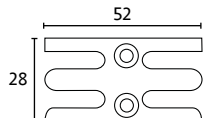

ESP-K6

68p each

**Single Mushroom or Roller keep**

- Ideal for slim rebates

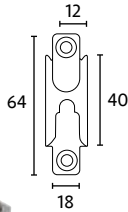

SDH-SMK

£1.01 each

**Flat Security Stabailising Plate**

- Silver finish



MA356088

£1.62 each

From our blog.



## WHY MANUFACTURE FRENCH CASEMENT WINDOWS WITH A FLYING MULLION?

Timber French windows are a popular choice for many homes throughout the UK, as they provide a timeless look, especially for older period-styled properties. Producing French casement windows with two sashes and a fixed centre mullion is one option when manufacturing a French window. However, not only does the centre mullion obstruct your view when both windows are open, it can also obstruct access, especially if the opening is required as a fire escape route. A solution for this is to manufacture a French window with what is referred to as a “flying mullion”, where instead of the mullion being part of the window frame, it is attached to a slave sash. When the window is closed, it looks like a normal French window and when both sashes are opened, there is an uninterrupted view and more importantly (when access is concerned) a wide enough opening to escape in an emergency. Fire regulations state that the minimum opening aperture should be 330mm width x 750mm height.

To achieve this style of window, during the manufacturing process the mullion would be machined separately and then screwed to the slave sash. Both the slave and master sashes would have their own



Joinery by: JTP Joinery

locking mechanisms and be fixed to the frame using friction hinges. If the window is to be used as a fire escape, then egress friction hinges would be recommended to maximize the width of the opening. For the locking mechanisms, we would recommend using the Excalibur Shootbolt system. On the slave window, you would use the Excalibur no claw option. Using the no claw option will allow you to fix the mullion to the slave window with a spacer block in between, as shown in the section drawing below. This slave window should be locked into position by shootbolts into thimble keeps located in the frame. For locking the master window there are a few options.



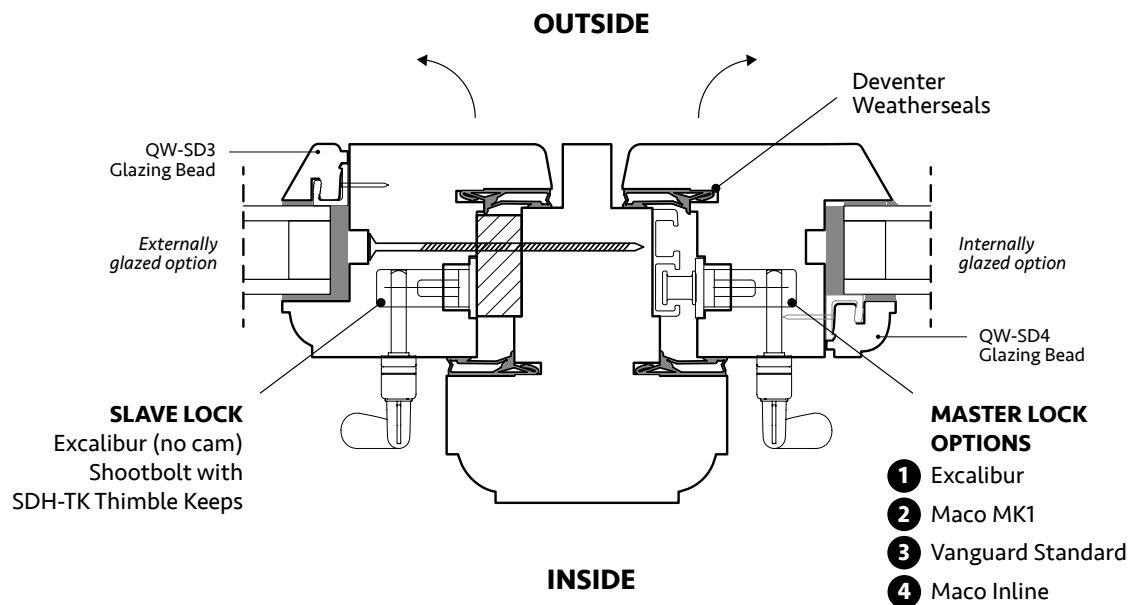
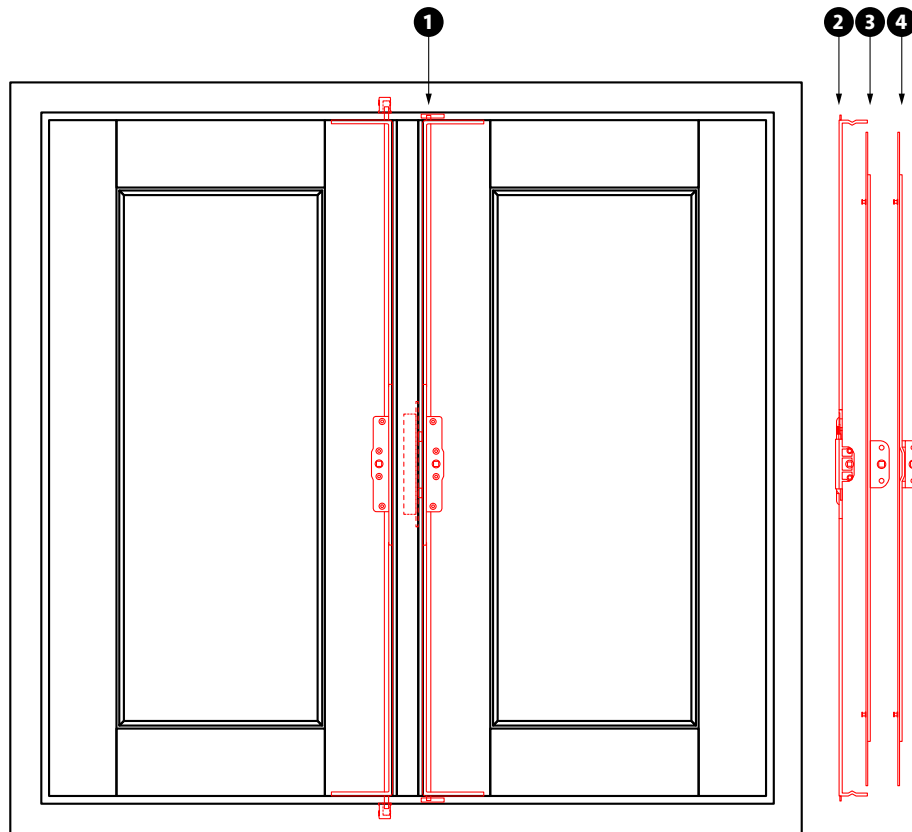

You could use the claw version of the Excalibur shootbolt system, with stormproof keeps fixed to the surface of the flying mullion. Other options include the Maco MK1, Maco Inline, or the Vanguard Standard. In the section drawing above there are suggestions for other products we recommend when producing this type of window.

If you're externally glazing your windows, we would recommend using the Qwood QW-SD3 Clip in Glazing Bead, and if internally glazing we recommend the Qwood QW-SD4 Clip in Glazing Bead.

For more information on tooling for manufacturing the flying mullion section please contact Whitehill Tooling.



EXTENSION DETAILS

This range of shootbolts and accessories is the most comprehensive system available to the timber window market. Its flexibility to be used in performance (12mm) and flush (4mm) systems is unrivalled. Designed for flush and stormproof Timber Windows. This locking system is highly secure and has been tested to PAS24.

FLUSH PROFILE SECTION

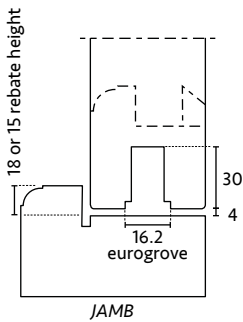

PERFORMANCE WINDOW SECTION

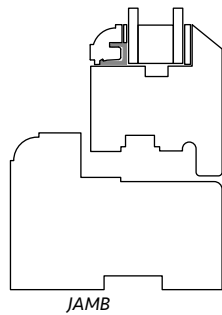

OFFSET WINDOW HEIGHTS FOR TALL WINDOWS

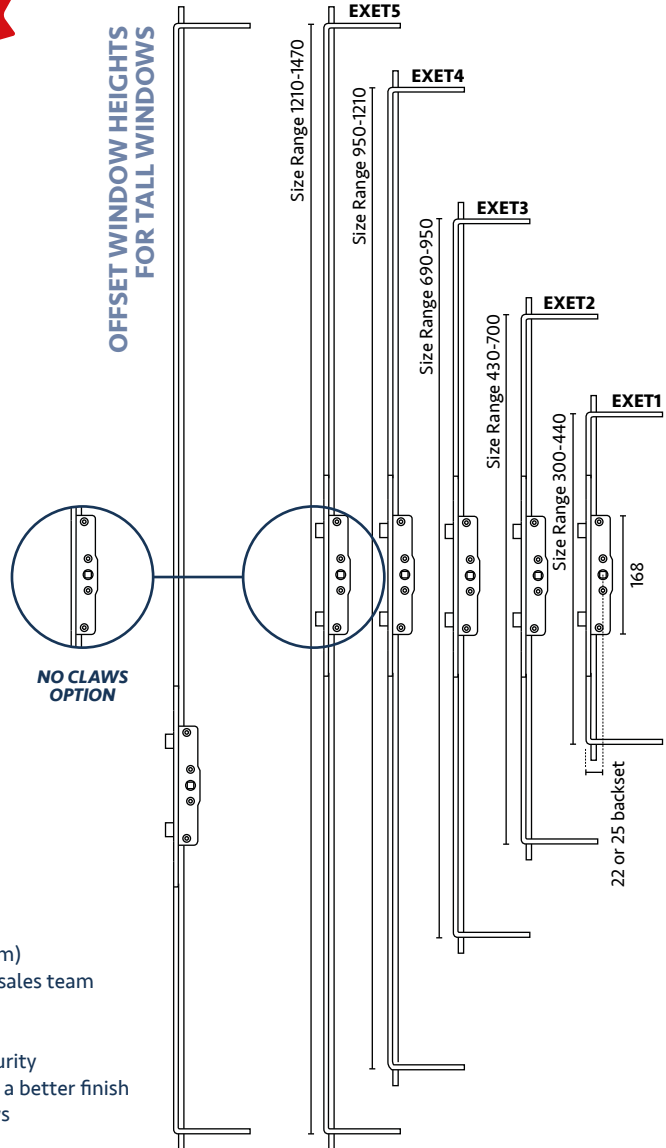

- Offset handle heights on tall windows for easy operation (see diagram)
- Short and tall window heights achieved with extensions, just let our sales team know your sash sizes and we'll work out the rest
- PAS24 security gearbox with reinforced retaining extension plate
- PAS24 range of keeps and accessories to achieve a higher level of security
- Fully pocketed flush keeps to help prevent water egress and achieves a better finish
- 5 different gearboxes for 22 & 25mm backsets with and without claws

Pocket Night Vent Keeps

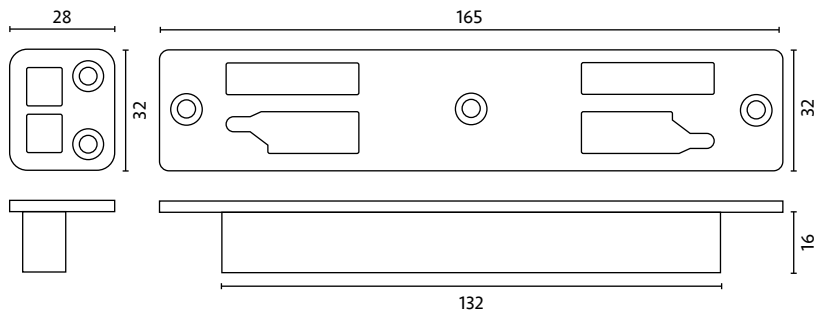

Centre Single Pocket Keep

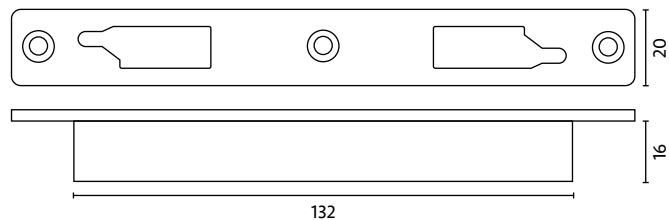

Why use Excalibur?

- 22mm or 25mm backset
- Very versatile
- Allows for offset handle heights
- No centre claw version available for French Casements with no flying mullion

## Gearbox

CODE	DESCRIPTION	PRICE
EXGB22	Excalibur Gearbox 22mm backset	£3.81
EXGB25	Excalibur Gearbox 25mm backset	£4.90
EXGB22-PAS24	Excalibur PAS24 Gearbox 22mm backset	£5.65
NO CLAW OPTION FOR FRENCH REBATED WINDOWS		
EXGB22-NC	Excalibur Gearbox 22mm backset (NO CLAWS)	£4.54
EXGB25-NC	Excalibur Gearbox 25mm backset (NO CLAWS)	£4.83



## Extensions

CODE	DESCRIPTION	PRICE
EXEXT1	Excalibur Extension 300 to 440mm (x2 required)	£1.23
EXEXT2	Excalibur Extension 430 to 700mm (x2 required)	£1.38
EXEXT3	Excalibur Extension 690 to 950mm (x2 required)	£1.59
EXEXT4	Excalibur Extension 950 to 1210mm (x2 required)	£2.39
EXEXT5	Excalibur Extension 1210 to 1470mm (x2 required)	£2.90



## Centre Keeps

	CODE	DESCRIPTION	PRICE
1	EXCLKEEP-CENTRE	Excalibur Centre Lock Keep 8mm Stormproof	£2.16
2	EXCLKEEP-FLAT	Excalibur Centre Lock Keep Flat Flush	£2.01
POCKETED KEEPS			
3	SDH-CNV-POK	Excalibur Centre Pocket Keep Flat Flush Night Vent	£2.82
4	SDH-SIN-POK	Excalibur Centre Pocket Keep Flat Flush Single	£2.82



## Shoot Bolt Keeps

	CODE	DESCRIPTION	PRICE
1	EXSBKEEP-FLAT	Excalibur Shoot Bolt Keep Flat Flush	67p
2	EXSBKEEP-LH	Excalibur Shootbolt Keep 8mm Stormproof L/H	68p
	EXSBKEEP-RH	Excalibur Shootbolt Keep 8mm Stormproof R/H	68p
3	EXSBKEEP-PQ-L	PAS24 Security Stormproof Shootbolt Keep L/H	79p
	EXSBKEEP-PQ-R	PAS24 Security Stormproof Shootbolt Keep R/H	79p
POCKETED KEEPS			
4	SDH-SBK-POK	Excalibur Shootbolt Pocket Keep 4mm Flush Night Vent	£1.06



## Accessories for PAS24

	CODE	DESCRIPTION	PRICE
1	EX7DEG-LH	Excalibur 7 Degree Shootbolt Wedge - Left Hand	94p
	EX7DEG-RH	Excalibur 7 Degree Shootbolt Wedge - Right Hand	94p
2	MA356088	Flat Security Stabilising Plate - Silver	£1.62



### Dummy Sash Lock

- Retention of dummy sashes with no fixings
- Sash easily removed and locked back in position
- Works for performance windows with 12mm tolerance
- 1 set comprises of 5 components to fit one corner of each sash
- Use 2 sets with friction hinges or 4 sets without (one in each corner)
- 1 pack has 20 corner sets (for 5 or 10 windows)

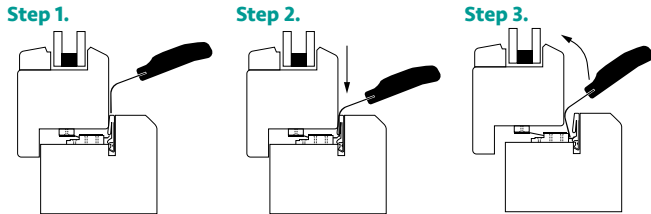

DSL

**£31.98**  
per pack of 20



SASH

FRAME

### HCD1

- Compression devices for Top Hung window (located on side of windows)
- 1 set comprises of 4 components to fit 1 sash
- Increases performance of weather tightness on top hung windows
- Can be fitted as remedial product
- Universally fits 12mm tolerance performance window
- Available in Brown or White

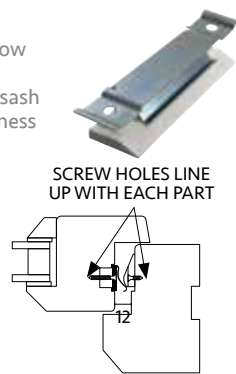

SCREW HOLES LINE UP WITH EACH PART

HCD1

**£3.90**  
per set

### HCD2

- Compression devices for side hung windows
- 1 set comprises of 2 components
- Located on the hinge side of the sash/frame
- Universally fits 12mm tolerance performance window
- Available in Brown or White



SCREW HOLES LINE UP WITH EACH PART

HCD2

**31p**  
per set

### Nico Heavy Duty Hinge

The Atlas Heavy Duty Friction Hinge range meets the increasing demand for larger and heavier windows. Top and side hung hinge variants accommodate sash weights of up to 60kg for Top Hung windows and 35kg for Side Hung windows. Increased bar thicknesses and additional fixing holes provide maximum stability and allow easy adjustment.

- Max. Vent weight of 35kg for Side Hung
- Max. Vent Weight of 60kg for Top Hung
- Stainless Steel riveted nose cap gives strength and reliability
- Glass reinforced nylon slide eliminates breaking and wear
- Brass adjustment screw provides adjustable friction
- 10 year mechanical guarantee
- 14mm Stack Height

### WHY USE?

- Carries heavier weights than standard hinges
- Stainless construction has exceptional corrosion resistance

NiCo



	Top or Side Hung	Top Hung
	<b>NICHD16</b>	<b>NICHD24</b>
Size	16"	24"
Max vent weight	35kg Side Hung / 45kg Top Hung	60kg Top Hung
Max vent height	1000mm Top Hung	1500mm
Max vent width	900mm Side Hung	-
<b>PRICE</b>	<b>£8.94</b> (Boxed in 20 Pairs)	<b>£11.55</b> (Boxed in 10 Pairs)

## Yale Friction Hinge

- Made from ferritic stainless steel
- 13mm stack heights
- Compatible with PVCu, timber and aluminium windows
- Endurance tested to 20,000 cycles
- Corrosion tested to 96 hours NSS
- Tested to BS 6375 Parts 1 & 2 for window performance: BS 6375-1:2015 classification for weather-tightness and guidance on selection and specification
- Tested to BS EN 1670
- Grade 3 corrosion resistance



### WHY USE?

- Secured by Design compliant when fitted with Yale ancillary security devices
- Most recognised brand in home security
- Delivers performance at a very competitive price



**10 YEAR MECHANICAL GUARANTEE**



	Top Hung				Side Hung		Universal	
	YALFH10TH	YALFH16TH	YALFH20TH	YALFH24TH	YALFH16SH	YALFH8T/SH	YALFH12T/SH	
Size	10"	16"	20"	24"	16"	8"	12"	
Max vent weight	16kg	21kg	24kg	35kg	24kg	12kg	22kg	
Max vent height	400mm	700mm	780mm	1000mm	1200mm	350mm (IF TOP HUNG)	550mm (IF TOP HUNG)	
Max vent width	-	-	-	-	-	400mm (IF SIDE HUNG)	600mm (IF SIDE HUNG)	
<b>PRICE</b>	<b>£2.59</b>	<b>£4.09</b>	<b>£4.89</b>	<b>£5.81</b>	<b>£4.33</b>	<b>£2.36</b>	<b>£3.05</b>	

## Nico Egress Restricted

The Nico Restricted Egress Friction Hinge combines the features of standard restrictor and egress only hinges. It provides protection against falling through windows in an initial restricted mode, and then offers a quick escape route in the event of a fire in the egress position.

- 13mm stack height

EACH PAIR OF HINGES HAS ONE RESTRICTED AND ONE NON RESTRICTED FOR EASE OF USE



### WHY USE?

- Child-resistant catch release for full opening, with automatic reset on closure
- BSI, BBA & SBD approved



	Side Hung	
	NIC8431	NIC8441
Size	12"	16"
Max vent weight	22kg	26kg
Max vent width	600mm	700mm
<b>PRICE</b>	<b>£7.88</b>	<b>£8.51</b>

## Cotswold Egress Easy Clean

Easy to operate to easy clean mode all from handle, no man handling sash.

- Full opening to 90°
- Conforms to BS6375 1&2
- Stainless Steel
- Plastic end caps
- BBA approved
- 13mm stack height



### WHY USE?

- Unique fitting position mode
- Best easy clean operation
- Competitive

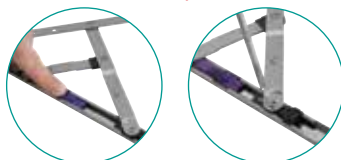

\*REDUCED PRICES



	Side Hung	
	COT-12-EE	COT-16-EE
Size	12"	16"
Max vent weight	18kg	21kg
Max vent height	1200mm	1200mm
Max vent width	600mm	600mm
<b>PRICE</b>	<b>£5.85*</b>	<b>£7.25*</b>

### Mega Egress Easy Clean

Some call these hinges 'Sumo' or 'Triad', however the trade name is 'Mega'. Both hinges can alleviate the binding issue associated with friction hinges and flush casement profiles.



\*REDUCED PRICES



#### WHY USE?

- Stainless Steel parts – Grade 430
- Plastic parts – GF Nylon
- Tested to BS EN 1670
- Tested to EN1191
- Open to full 90°
- 13.5mm stack height
- Immobilizer to be fitted to easy clean sash width of above 600mm
- Heavy carrying weights
- 8" perfect for French Casements
- Simple easy clean facility



Side Hung

	QEGE8 (Egress Only)	QEGE13
Size	8"	13"
Max vent weight	33kg	40kg
Max vent width	600mm	900mm
<b>PRICE</b>	<b>£8.44*</b>	<b>£10.99*</b>

### Defender Egress Only

- Handed for better compression
- 10 year guarantee
- Tested to 30,000 cycles
- 13mm stack height
- Side hung only
- 80° opening



#### WHY USE?

- Top brand
- Variable friction adjustment
- Consistent performance

Side Hung

	SECEO12	SECEO16
Size	12"	16"
Max vent weight	22kg	24kg
Max vent width	400mm	700mm
<b>PRICE</b>	<b>£9.67</b>	<b>£9.77</b>

### Window Restrictor

This product is perfect for creating friction and restriction on windows and doors where there is not enough clearance to use a Friction hinge.



- Tested to BS6375:2, withstanding a 350N force for a period of 1 minute
- Manufactured in the UK
- Fits in standard Euro groove
- Adjustable friction control
- Solid stainless steel construction
- No disengagement (permanent restriction)
- Non handed

Side Hung

	RS6	RS10
Size	6"	10"
Max vent weight	22kg	24kg
Max vent width	400mm	700mm
<b>PRICE</b>	<b>£6.39</b>	<b>£7.23</b>

### Defender Timber Variant

The UK's premium friction hinge for timber windows.

- Handed for better compression
- Low timber variant end cap for less binding
- 10 year guarantee
- Tested to 30,000 cycles
- 13mm stack height
- Side or top hung
- 304 Ferretic

#### WHY USE?

- Lipped slider for smooth operation
- Reduced end cap for no debris ingress



TIMBER VARIANT DETAIL



Top Hung

Side Hung

Universal

	SECTH10	SECTH12	SECTH16	SECTH20	SECTH24	SECSH12	SECSH16	SECT-SH08
Size	10"	12"	16"	20"	24"	12"	16"	8"
Max vent weight (kg)	16kg	20kg	21kg	26kg	40kg	22kg	24kg	12kg/18kg
Max vent height	400mm	550mm	780mm	1100mm	1300mm	-	-	350mm
Max vent width	-	-	-	-	-	600mm	700mm	400mm
<b>PRICE</b>	<b>£5.13</b>	<b>£5.99</b>	<b>£7.44</b>	<b>£8.39</b>	<b>£9.80</b>	<b>£6.77</b>	<b>£9.14</b>	<b>£4.77</b>

### Royal Hinge Easy Clean Egress

This hinge works well on flush casement performance windows where binding is an issue.

- 14mm stack height
- Includes easy clean facility
- Stainless Steel
- Safer than most egress stays
- Incorporates a positive mechanical stop
- Maximum sash width of 900mm
- 14mm stack height



#### WHY USE?

- Eliminates binding issues
- Unique product
- 3 benefits in 1 hinge - Heavy Duty, Easy Clean and Egress



Side Hung

	<b>ROY14EE</b>
Size	14"
Max vent weight	45kg
Max vent width	900mm
<b>PRICE</b>	<b>£14.02</b>

### ERA Horizon Standard & Easy Clean Friction Hinges

- 13mm stack height
- High quality stainless steel for long life
- Durable and reliable design
- Pointed arm and nylon end cap provide gasket compression and smooth engagement
- Adjustable opening positioning
- Enhanced security compliant when fitted with a separate hingeuard

#### WHY USE?

- Top brand
- Standard or Easy Clean available



Top Hung

Side Hung

Easy Clean (Side Hung)

	PQ-FST8	PQ-FST10	PQ-FST12	PQ-FST16	PQ-FST20	PQ-FST24	PQ-FSS12	PQ-FSS16	PQ-FSEG12	PQ-FSEG16
Size	8"	10"	12"	16"	20"	24"	12"	16"	12"	16"
Max vent weight (kg)	14kg	18kg	22kg	23kg	28kg	48kg	24kg	26kg	22kg	24kg
Max vent height	350mm	400mm	550mm	780mm	1100mm	1300mm	-	-	600mm	700mm
Max vent width	-	-	-	-	-	-	600mm	700mm	1200mm	1300mm
<b>PRICE</b>	<b>£4.03</b>	<b>£4.03</b>	<b>£4.90</b>	<b>£6.04</b>	<b>£6.93</b>	<b>£9.87</b>	<b>£5.16</b>	<b>£5.83</b>	<b>£10.32</b>	<b>£10.67</b>

### Hinge Packer

- Designed for bevelled cill of 7-9 degrees to square friction hinge
- 410mm length

FHP

**£2.71**  
each

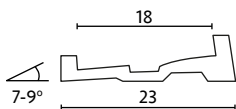

### Friction Hinge Screws

- Specially designed for friction hinges
- Austenitic
- Sold and priced per 1000
- 4.3mm x 25mm



### Riser Block

Helps the sash locate correctly into the frame, usually fitted to the hinge side it can help correct out of line sashes on casement windows.



- White or brown
- L35 x W25 x H12mm
- Aids security (Used in PAS24 test)

RUB-WH/BR

**32p**  
each

FHS4325

**£59.69**  
per 1000

### Maco™ Non-Locking Window Restrictor

- PAS24 tested
- 11.5mm stud height
- Restricts sash to 100mm opening
- Handed (left-hand shown)
- Restrictor and pin priced separately
- Stainless Steel

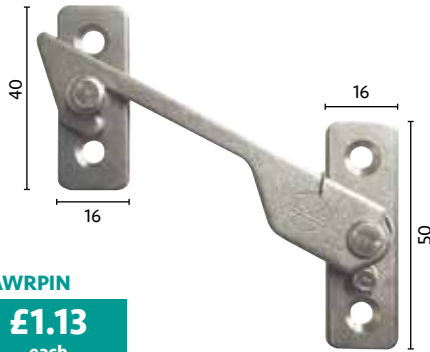

**MAWR LH/RH**  
**£4.38**  
each

**MAWRPIN**  
**£1.13**  
each

### Key Locking Restrictor & Pin

- Automatic locking
- Automatic engagement
- Concealed fitting
- Restricts sash to 100mm opening
- Dedicated key release
- Retro fitting option
- Suitable for all window styles: PVCu, Aluminium & Timber
- Conforms to BS EN 14351:2006 Clause 4.8
- Constructed from stainless steel and zinc alloy
- Handed



**Restrictor**  
**VLR-LH/RH**  
**£9.43**  
each

**Pin**  
**VLR-PIN**  
**£1.59**  
each

### SAC Bolt & Keep™ Side Security System

The SAC Bolt & Keep is the only single product that can improve window performance all year round

- Improves security
- Improves weather and sound insulation
- Improves hinge reliability
- Improves closing operation of the window
- A cost effective security upgrade that can really make a difference
- For hinged side of window

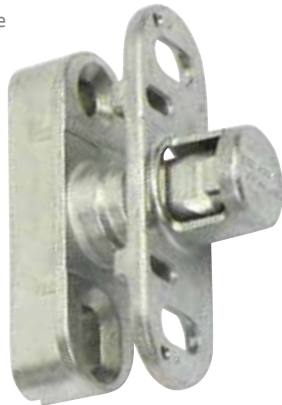

**AS1/2-KIT**

**£2.10**  
per set

### Vanguard Security Lockable Window Restrictor

- Strength tests to forces over 100kg when the cable is locked in the mechanism (the industry standard is 50kg!)
- Stainless Steel wire
- Complete with key

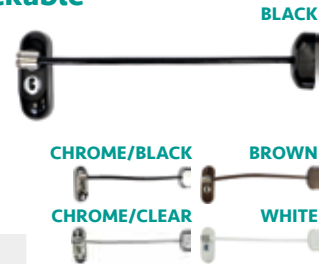

**CWR-** from £10.05

### ERA Sash Jammer Kit

- Easy to install with or without the need for additional locking (Key provided).
- Local Authorities and Housing Associations recommend it to boost domestic security.



WHITE: ERA-7A002 £5.47  
BROWN: ERA-7A005

### ASD Security Device

- For securing hinged side of sash
- Tested and exceeded PAS24
- 10 Year technical guarantee
- Sold as set of 4



**securistyle**

**ASD1**

**£3.80**  
per set of 4

**10 YEAR MECHANICAL GUARANTEE**

### Maco™ Surface Tilt Restrictor

- Great for retro fit
- Non-handed
- Available in white



**MA1236**

**£17.06**  
each

### Roto Tilt & Turn

We are able to quote for Roto invisible Tilt & Turn. Tight Sash rebate sizes required.

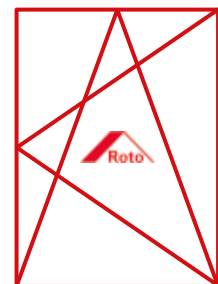

**PLEASE CONTACT OUR SALES TEAM**

**MANY MORE ANCILLARY PRODUCTS AVAILABLE ONLINE**



## Yale Slim Vent Trickle Vent & Canopy Set

- Meets the requirements of revised Document F (England & Wales) and Scottish Building Regulations Standard 3.14
- Tested at BRE to EN13141-1:2019 and BS EN ISO 10140-1
- Easy fixing: Clip-fit (for UPVC) or screw fix (for timber)
- Strong ASA construction
- Yale 10 Year mechanical guarantee
- Yale 1 Year surface finish guarantee
- Trickle Vent and canopy
- 2500mm<sup>2</sup> EA (252mm x 21mm) or 4000mm<sup>2</sup> EA (386mm x 21mm)

Available Finishes: White, Black or Anthracite Grey

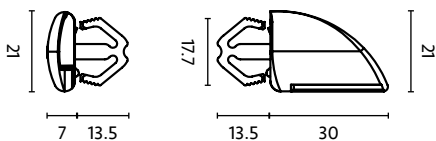

2500<sup>2</sup> EA  
YSV2500

**£2.57**  
ex VAT

4000<sup>2</sup> EA  
YSV4000

**£2.87**  
ex VAT

Clip-fit or  
screw fix



TECHNICAL DRAWINGS AVAILABLE, PLEASE ASK FOR DETAILS.

## Titon SF Xtra High Performance Aluminium Vent

The SF Xtra is a high performance, surface mounted aluminium slot ventilator. It is the shortest vent available to provide 5000mm<sup>2</sup> EA.

- Simple construction to aid painting, self-assembly & fitting
- For use over a 13 or 16mm slot
- Gasket combines with compression closing action improves sealing in adverse conditions
- Ideal for retrofit applications, over a slot or series of holes
- Available in White, Brown, Black and Anthracite Grey (Special order)

294mm Vent  
SFX13 4000<sup>2</sup> EA  
TA7831

**£4.30**  
ex VAT

SF318 Canopy  
TA5010

**£3.80**  
ex VAT

434mm Vent  
SFX13 4000<sup>2</sup> EA  
TA7833

**£4.70**  
ex VAT

SF418 Canopy  
TA5005

**£4.80**  
ex VAT



# joinersforum<sup>®</sup>

Join the community and connect with other joiners in the industry.

[www.joinersforum.com](http://www.joinersforum.com)

## HOW TO JOIN

- Visit [www.joinersforum.com](http://www.joinersforum.com) or scan the QR code
- Request to join or sign in
- Download the Mighty Networks app to use on the go



IDEAS & SUPPORT



ADVICE & CHAT



SHARE WORK

SCAN TO SIGN UP AND LOGIN



### Trimvent 90 Hi Lift

- Semi-recessed aluminium slot ventilator that fits over a 16mm slot
- Ideal for both new build or refurbishment jobs
- Felted gasket for increased performance
- Available in white, brown or (black & other colours special order)

**TV90-250 (Equivalent Area Airflow of up to 2200mm<sup>2</sup>)**  
300mm (250 x 22mm) Slot size (212 x 16mm)

**TV90-300 (Equivalent Area Airflow of up to 2500mm<sup>2</sup>)**  
300mm (300 x 22mm) Slot size (262 x 16mm)

**TV90-425 (Equivalent Area Airflow of up to 4300mm<sup>2</sup>)**  
425mm (425 x 22mm) Slot size (387 x 16mm)

**TV90-250**

**£10.08**  
ex VAT

**TV90-300**

**£15.26**  
ex VAT

**TV90-425**

**£9.73**  
ex VAT



**Slot Sizes**

**TV90-250**



**TV90-300**



**TV90-425**



### Trimvent 90 Hi Lift & Trykvent Canopy

- Canopy to suit above Trimvent 90 vent & Trykvent
- Features integral screw covers
- Available in white, brown or (black & other colours special order)
- Special ral colours available to order

**TV90C-263** - 263 x 24mm

**TV90C-303** - 303 x 24mm

**TV90C-441** - 441 x 24mm

**TV90C-263**

**£5.03**  
ex VAT

**TV90C-303**

**£4.18**  
ex VAT

**TV90C-441**

**£6.15**  
ex VAT



### Trykvent

- Specifically designed for high performance timber windows
- Easily removed without damage to product
- High quality, robust operating mechanism
- Available in White or Brown
- Available in 2 sizes
- XC16 Canopy, PG16 or GN16 Grilles can be used with this vent as an option
- Can be used with TV90 Canopy (above)

**TRK283 (Equivalent Area Airflow of up to 3000mm<sup>2</sup>)**  
283mm (283 x 27mm) Slot size (151 x 10 x 151 x 16mm)

**TRK389 (Equivalent Area Airflow of up to 4300mm<sup>2</sup>)**  
389mm (389 x 27mm) Slot size (226 x 16mm)

**TRK283**

**£7.21\***  
ex VAT

**TRK389**

**£7.55\***  
ex VAT



**\*REDUCED PRICES**

**Slot Sizes**

**TRK283**



**TRK389**



### GN16 Grille

- Grille to fit XS16 & XR16 (2 x 148mm)
- Push in grille for 16mm slot
- Available in Brown or White

**GN16-GRILL**

**£2.32**  
per pair

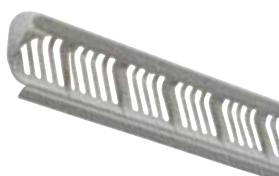

### Flat Aluminium Grille

- Suitable for use with TV4000 Trickle Vent
- 380mm x 22mm
- Available in White or Brown

**White TH275-020**

**£6.20**  
per pair

**Brown TH275-023**

**£6.53**  
per pair



### Trimvent Select XS16/XS13/S13

- Surface mounted vent
- Sleek design
- Available in Brown or White
- Easy operation
- Overall slot size: **XS16:** 312 x 16mm, **XS13:** 367 x 13mm **S13:** 223 x 13mm
- Airflows: **XS16:** 4600mm<sup>2</sup> **XS13:** 4400mm<sup>2</sup> **S13:** 1700mm<sup>2</sup>

<b>XS16VENT</b>	<b>XS13VENT</b>
<b>£4.60</b> ex VAT	<b>£5.35</b> ex VAT

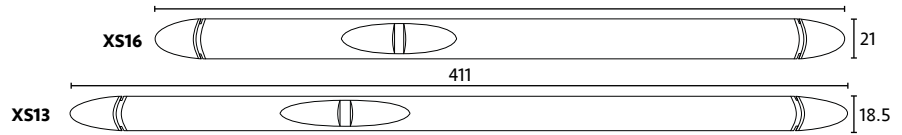

### Trimvent Select XR16

- Flush fit recessed vent
- Available in White, Brown, Black and Anthracite Grey
- Easy operation
- Product length: 351 x 22mm
- Overall slot size: 312 x 16mm (22mm recess)
- **Equivalent Area Airflow of up to 4600mm<sup>2</sup>**

<b>XR16VENT</b>
<b>£4.84</b> ex VAT

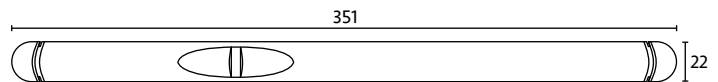

### Trimvent Canopy XC16/XC13/C13

- Canopies to fit XS16 & XR16
- Available in Brown or White

<b>XC16CANOPY</b>	<b>XC13CANOPY</b>
<b>£2.06</b> ex VAT	<b>£1.83</b> ex VAT

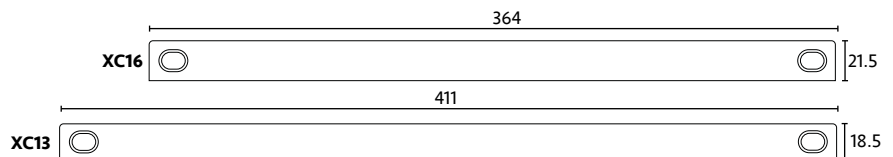

### Trimvent 4000 Hi Lift Vent

This range of vents are manufactured from aluminium giving your window a high end feel. Manufactured by Titon™

TV2000HL 2200mm<sup>2</sup> Equivalent Airflow  
TV4000HL 4000mm<sup>2</sup> Equivalent Airflow

Slot size Vent 174x20x174mm (13x368mm)  
Slot size Canopy (13x354mm)

Available in Black, Brown and White.

Use with TV90C Canopies



Vent <b>TVV2000HL</b>	Vent <b>TVV4000HL</b>
<b>£8.09</b> ex VAT	<b>£10.03</b> ex VAT



### Devoran Monkey Tail Espag Handle

- Narrow back plate (18mm)
- Locking
- Complete with screws
- 40mm spindle
- Handed
- Matching Stay available



Black  
DEV-ESP

Pewter  
DEV-ESP

**£6.17**  
ex VAT

**£6.70**  
ex VAT



### SOX Stainless Steel Espag Handle

- Contemporary round bar design
- Complete with 35mm spindle and machine screws
- Locking
- Handed
- Matching Stay available



SOX-ESP

**£17.99**  
ex VAT



### Isca Espag Handle

- Narrow back plate (20mm)
- Complete with machine screws & key
- Available in Polished Brass, Polished Chrome, Satin Chrome & Florentine Bronze
- 40mm spindle
- Handed
- Locking

ISPC/SC/FB

**£14.30**  
ANY FINISH



### Stainless Steel Non-Espag Handle

- Handed
- Locking
- Complete with mortice plate screws
- Night vent position on mortice plate option



SOXCH

**£24.76**  
ex VAT

### Hook Plate

- To suit flush window profile

SOXHP

**£9.93**  
ex VAT



### Stainless Steel (Marine Grade) Machine Screws

40mm M5 Machine Screws for window handles.

- Recommended for use with Accoya
- Replacement for mild steel screws supplied with window handles



MS-M5-40

**57p**  
ex VAT

### Stainless Steel Stay

- 260mm length
- Complete with 2 pins and screws



SOXSTAY260

**£22.26**  
ex VAT





# CORNISH HERITAGE

COLLECTION

**Cornish Heritage Window Handles and Stays have been crafted to give the style and feel of a traditional handle but manufactured using modern techniques. Zinc Cast for extra durability, these handles and stays are consistent in finish and dimensions.**

Available in monkey tail and tear drop, the espag handle is lockable via a key.

The stay can be used as a traditional stay (with pegs) or the dummy stay where friction hinges are used but will still allow a traditional look.



## Monkey Tail or Tear Drop Espag Handle

- Exceeds BSEN1670
- Available in White, Polished Gold, Polished Chrome, Smokey Chrome, Satin Chrome, Black & Mottled Grey
- Complete with 40mm spindle and machine screws
- Matching stays available (below)
- Lockable with key
- Handed

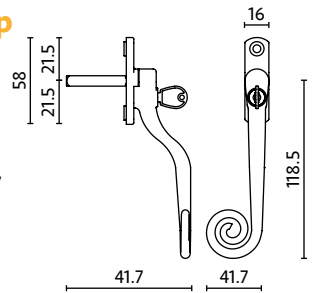

**10 YEAR MECHANICAL GUARANTEE**

**240hrs SALT SPRAY TESTED**

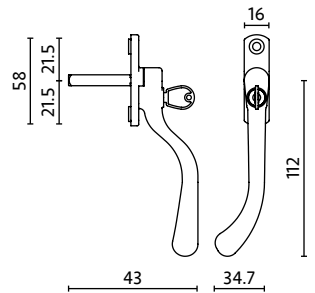

CH-MT/TD-LH/RH

**£7.92**  
ANY FINISH

## Tear Drop Stay

- Available in White, Polished Gold, Polished Chrome, Smokey Chrome, Satin Chrome, Black & Mottled Grey

CH-TD-STAY-SET

**£14.66\***  
PREMIUM FINISHES

**£10.33\***  
WHITE

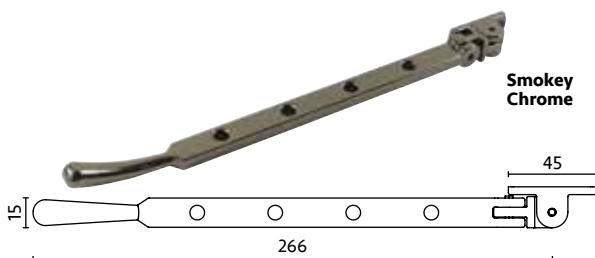

## Monkey Tail Stay

- Available in White, Polished Gold, Polished Chrome, Smokey Chrome, Satin Chrome, Black & Mottled Grey

CH-MT-STAY-SET

**£14.66\***  
PREMIUM FINISHES

**£11.14\***  
WHITE

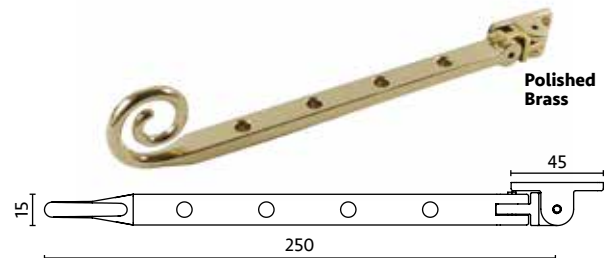

### Timber Series Guru Cranked Locking Window Fastener

The Timber Series Guru Locking Window Fastener is suited to the timber series range and has a classic design with a contemporary twist to create an elegant and stylish window.

- Left and right hand available
- Heavyweight locking handle with solid die-cast construction
- Perfectly matching slimline and standard keeps available
- Match with the Timber Series collection of stays
- Supplied with colour-coordinated screws
- BS EN 1670:2007 Grade 5 (480 hours) Corrosion Resistance
- Tested to in excess of 50,000 cycles
- Grade 5 Corrosion Resistance (480 hours)



<b>GURU-RH/LH</b>	<b>GURU-KEEP</b>	<b>HG</b>	<b>PC</b>	<b>PS</b>	<b>BL</b>	<b>HB</b>	<b>ABL</b>	<b>WH</b>
from <b>£8.20</b> ex VAT	from <b>£1.03</b> ex VAT							

### Timber Series Fastener

- Solid die-cast construction
- Supplied with matching fixings
- Tested to 50000 cycles
- Non-Handed

Available in Hardex Gold, Hardex Chrome, Premium Satin, Black, Hardex Bronze, Antique Black & White

**10 YEAR MECHANICAL GUARANTEE**

**480hrs SALT SPRAY GUARANTEE**

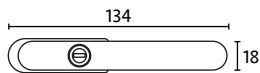

<b>TSLF-LOCKING</b>	<b>TSNLF-NON-LOCKING</b>	<b>HG</b>	<b>HC</b>	<b>PS</b>	<b>BL</b>	<b>HB</b>	<b>ABL</b>	<b>WH</b>
from <b>£6.87</b> ex VAT	from <b>£7.07</b> ex VAT							

### Timber Series Stay

- Locking or Non-Locking
- Non-handed: will fit left and right-hand windows
- Supplied including machine screws
- Length: 279mm
- Width: 16mm

Available in Hardex Gold, Hardex Chrome, Premium Satin, Black, Hardex Bronze, Antique Black & White

**10 YEAR MECHANICAL GUARANTEE**

**480hrs SALT SPRAY GUARANTEE**

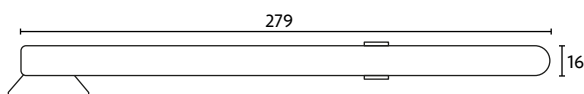

<b>TSLS-LOCKING</b>	<b>TSNLS-NON-LOCKING</b>	<b>HG</b>	<b>HC</b>	<b>PS</b>	<b>BL</b>	<b>HB</b>	<b>ABL</b>	<b>WH</b>
from <b>£9.33</b> ex VAT	from <b>£8.82</b> ex VAT							

## Timber Series Connoisseur MK1 Offset Espag Handle

- 40mm spindle
- Complete with machine screws
- Handed
- Finish swatches below

TSECLH/RH  
SC/BC/HG

TSECLH/RH  
WH/BL

from  
**£5.43**  
ex VAT

from  
**£3.99**  
ex VAT



## TIMBERSERIES

*Timber Series is a collection of suited Window & Door hardware that provides a uniform aesthetic across all of your Joinery.*

## Timber Series Connoisseur MK2 Offset Locking Espag Window Handle

- Solid die-cast construction ensures durability with heavyweight and sturdy feel for a reliable grip
- Heavy-duty sprung latching wedge adds extra security
- Long handle provides greater leverage and smooth operation without hand catching
- Cover caps with a colour-coordinated finish for a polished look
- Certified by Secured By Design for enhanced security
- Key included clicks securely into place upon insertion
- Comes with a complete screw and spindle pack for easy installation
- Handed

**Available in the following finishes:** Anthracite Grey, Antique Black, Black, Graphite, Hardex Bronze, Hardex Chrome, Hardex Gold, Rose, Premium Satin, White

**10 YEAR MECHANICAL GUARANTEE**



**480hrs SALT SPRAY GUARANTEE**

TSEOF  
GRA/HB/HC/  
HG/RO/ABL

TSEOFRH/LH  
WH/BL/A/SA

from  
**£5.48**  
ex VAT

from  
**£2.32**  
ex VAT



## Timber Series Connoisseur MK2 Inline Locking Espag Window Handle

- Solid die-cast construction ensures durability with heavyweight and sturdy feel for a reliable grip
- Heavy-duty sprung latching wedge adds extra security
- Long handle provides greater leverage and smooth operation without hand catching
- Cover caps with a colour-coordinated finish for a polished look
- Certified by Secured By Design for enhanced security
- Key included clicks securely into place upon insertion
- Comes with a complete screw and spindle pack for easy installation
- Non-Handed

**Available in the following finishes:** Anthracite Grey, Antique Black, Black, Graphite, Hardex Bronze, Hardex Chrome, Hardex Gold, Rose, Premium Satin, White

**10 YEAR MECHANICAL GUARANTEE**



**480hrs SALT SPRAY GUARANTEE**

TSEIL  
GRA/HB/HC/  
HG/RO/ABL

TSEIL  
WH/BL/A/SA

from  
**£5.03**  
ex VAT

from  
**£2.20**  
ex VAT



### Teardrop Espag handle

- Handle Length: 127mm
- Fixing Plate: 55mm x 16mm
- Available in 4 finishes

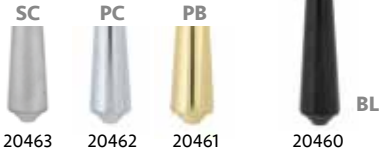

from **£17.62** ex VAT

DIFFERENT PEAR DROP STYLES AVAILABLE

### Peardrop Espag handle

- Handed
- Handle Length: 115mm
- Fixing Plate: 66mm x 20mm
- Available in 2 finishes



from **£22.00** ex VAT

### Shepherd's Crook Espag handle

- Handed
- Handle Length: 103mm
- Fixing Plate: 66mm x 20mm
- Available in 2 finishes



from **£22.24** ex VAT

### Reeded Espag Handle

- Very stylish, made from Solid Brass
- 69mm x 15mm fixing plate
- Complete with 40mm spindle fixings
- Handed

**Finishes available:**  
 Aged Brass (83913/5)  
 Polished Nickel (83914/6)  
 Polished Chrome (90331/2)  
 Aged Bronze (83972/3)  
 Polished Bronze (91942/3)  
 Polished Brass (46709/10)



FINISH	PRICE
Aged Brass	£43.77
Polished Nickel	£48.35
Polished Chrome	£48.35
Aged Bronze	£55.46
Polished Bronze	£54.95
Polished Brass	£43.77

### Newbury Espag Handle

- Very stylish, made from Solid Brass
- 69mm x 15mm fixing plate
- Complete with 40mm spindle fixings
- Handed

**Finishes available:**  
 Aged Brass (91443/4)  
 Polished Nickel (91457/8)  
 Polished Chrome (91450/1)  
 Aged Bronze (91464/5)  
 Polished Bronze (91953/4)  
 Polished Brass (46527/8)



FINISH	PRICE
Aged Brass	£43.76
Polished Nickel	£48.30
Polished Chrome	£50.76
Aged Bronze	£55.46
Polished Bronze	£55.46
Polished Brass	£43.73

### Brompton Espag Handle

- 68mm x 16mm fixing plate
- Complete with 40mm spindle fixings
- Handed

**Finishes available:**  
 Black (46163/4)  
 Matt Black (46165/6)  
 Pewter (46167/8)  
 Aged Brass (91443/4)  
 Polished Nickel (91457/8)  
 Polished Chrome (91450/1)  
 Aged Bronze (91464/5)  
 Polished Bronze (91953/4)  
 Polished Brass (50613/4)



FINISH	PRICE
Black	£30.30
Matt Black	£31.81
Pewter	£33.16
Aged Brass	£43.76
Polished Nickel	£48.30
Polished Chrome	£50.76
Aged Bronze	£55.46
Polished Bronze	£55.46
Polished Brass	£49.88

### Hinton Espag handle

- Handle Length: 142mm
- Fixing Plate: 69mm x 16mm
- 43mm centres
- Left or Right hand available

FINISH	PRICE
Aged Brass	£52.48
Polished Chrome	£52.48
Polished Nickel	£57.99
Polished Bronze	£66.49
Aged Bronze	£66.56
Polished Brass	£52.48



WE CAN SOURCE ALL ANVIL PRODUCTS AT COMPETITIVE PRICES, PLEASE ASK FOR PRICES.



From the  
**Anvil**

From The Anvil uses mild steel as the core material. CNC Technology mixed with Hot Forging and traditional 'Anvil' hammer work, produces beautiful and functional products.



### Peardrop End Non-Locking Stay

Overall Lengths:  
8" Length: 9" (230mm)  
10" Length: 10 1/2" (280mm)  
12" Length: 12 1/2" (320mm)



8" BLACK 8" PEWTER

**£11.42**  
33291

**£17.40**  
33677

10" BLACK 10" PEWTER

**£12.57**  
33292

**£19.25**  
33678

12" BLACK 12" PEWTER

**£13.98**  
33293

**£21.43**  
33679

### Monkey Tail End Non-Locking Stay

Overall Lengths:  
8" Length: 9" (222mm)  
10" Length: 10 1/2" (272mm)  
12" Length: 12 1/2" (320mm)



8" BLACK 8" PEWTER

**£11.42**  
33281

**£17.41**  
33630

10" BLACK 10" PEWTER

**£12.64**  
33282

**£20.43**  
33631

12" BLACK 12" PEWTER

**£13.98**  
33283

**£21.94**  
33632

### Shepherd's Crook End Non-Locking Stay

Overall Lengths:  
8" Length: 9" (265mm)  
10" Length: 10 1/2" (315mm)  
12" Length: 12 1/2" (360mm)



8" BLACK 8" PEWTER

**£14.03**  
33960

**£17.44**  
33605

10" BLACK 10" PEWTER

**£15.49**  
33961

**£20.46**  
33606

12" BLACK 12" PEWTER

**£16.00**  
33962

**£21.94**  
33607

WE CAN SOURCE ALL ANVIL PRODUCTS AT **COMPETITIVE PRICES**, PLEASE ASK FOR PRICES.

**FOR FULL PRODUCT RANGE,  
TECHNICAL DRAWINGS &  
IMAGES OF ALL FINISHES  
PLEASE VISIT**

[sdhardware.co.uk/brands/devoran](http://sdhardware.co.uk/brands/devoran)

SCAN TO VIEW  
FULL RANGE



**1** **DEVMTST8/10/12PE**  
**Pewter Monkey Tail Stay**  
8 Inch £9.11 each  
10 Inch £10.05 each  
12 Inch £10.43 each

**2** **DEVMTST8/10/12BL**  
**Black Monkey Tail Stay**  
8 Inch £3.34 each  
10 Inch £3.97 each  
12 Inch £4.15 each

**6** **DEVMTFPE**  
**Pewter Monkey Tail Fastener**  
£9.11 each

**6** **DEVMTFBL**  
**Black Monkey Tail Fastener**  
£3.50 each

**3** **DEV90-PE-8/10/12**  
**Pewter Shepherd's Crook Stay**  
8 Inch £8.86 each  
10 Inch £9.73 each  
12 Inch £10.60 each



**4** **DEVLFB**  
**Black Monkey Tail Lockable Fastener**  
£6.52 each

**5** **DEV90**  
**Pewter Shepherd's Crook Fastener**  
£9.71 each

Devoran Antique Hardware is a collection of competitively priced window & door furniture for properties requiring traditionally styled ironmongery.

ANTIQUE  
  
 DEVORAN  
 HARDWARE

7 FA-LOCK-PIN (PW)

**Locking Pins**  
**Black or Pewter**  
 £3.70 each



8 DEV105-BL

**Black Bulb End Stay**  
 8 Inch £11.41 each  
 10 Inch £12.79 each  
 12 Inch £13.31 each

9 DEV105-PE

**Pewter Bulb End Stay**  
 8 Inch £11.41 each  
 10 Inch £12.79 each  
 12 Inch £13.31 each

10 DEVBUST

**Black Swirl End Stay**  
 8 Inch £3.88 each  
 10 Inch £4.15 each  
 12 Inch £4.42 each



11 DEV106-BL

**Black Bulb End Fastener**  
 £11.63 each

11 DEV106-PE

**Pewter Bulb End Fastener**  
 £11.63 each

12 DEVBUFBL

**Black Swirl End Fastener**  
 £2.91 each

# DART

## BRASS COLLECTION

This collection of Brass window furniture offers a range of styles and finishes that are functional and competitively priced. Traditionally designed and manufactured, available in a variety of finishes.

1 DAR-114-8/10/12

### Monkey Tail Stay

8, 10 or 12 Inch  
from **£5.59 each**

SNP

2 DAR-007-8/10/12

### Bulb End Stay

8, 10 or 12 Inch  
from **£6.61 each**

SNP

3 DAR-115-8/10/12

### Reeded Stay

8, 10 or 12 Inch  
from **£6.61 each**

4 DAR-117-8/10/12

### Spoon End Stay

8, 10 or 12 Inch  
from **£5.59 each**

SNP

5 DAR-010

### Tear Drop Fastener

with hook & Mortice Plate  
from **£5.14 each**

6 DAR-007

### Bulb End Fastener

with hook & Mortice Plate  
from **£5.40 each**

SNP

7 DAR-114

### Monkey Tail Fastener

with hook & Mortice Plate  
from **£5.22 each**

SNP

8 DAR-116

### Spoon End Fastener

with hook & Mortice Plate  
from **£4.64 each**

SNP

9 DAR-115

### Reeded Fastener

with hook & Mortice Plate  
from **£5.68 each**

10 DAR-011

### Victorian Fastener

with wedge plate  
from **£3.26 each**

SNP Also available in  
Satin Nickel Plated

POLISHED CHROME  
POLISHED BRASS  
SATIN CHROME  
ANTIQUÉ BRASS

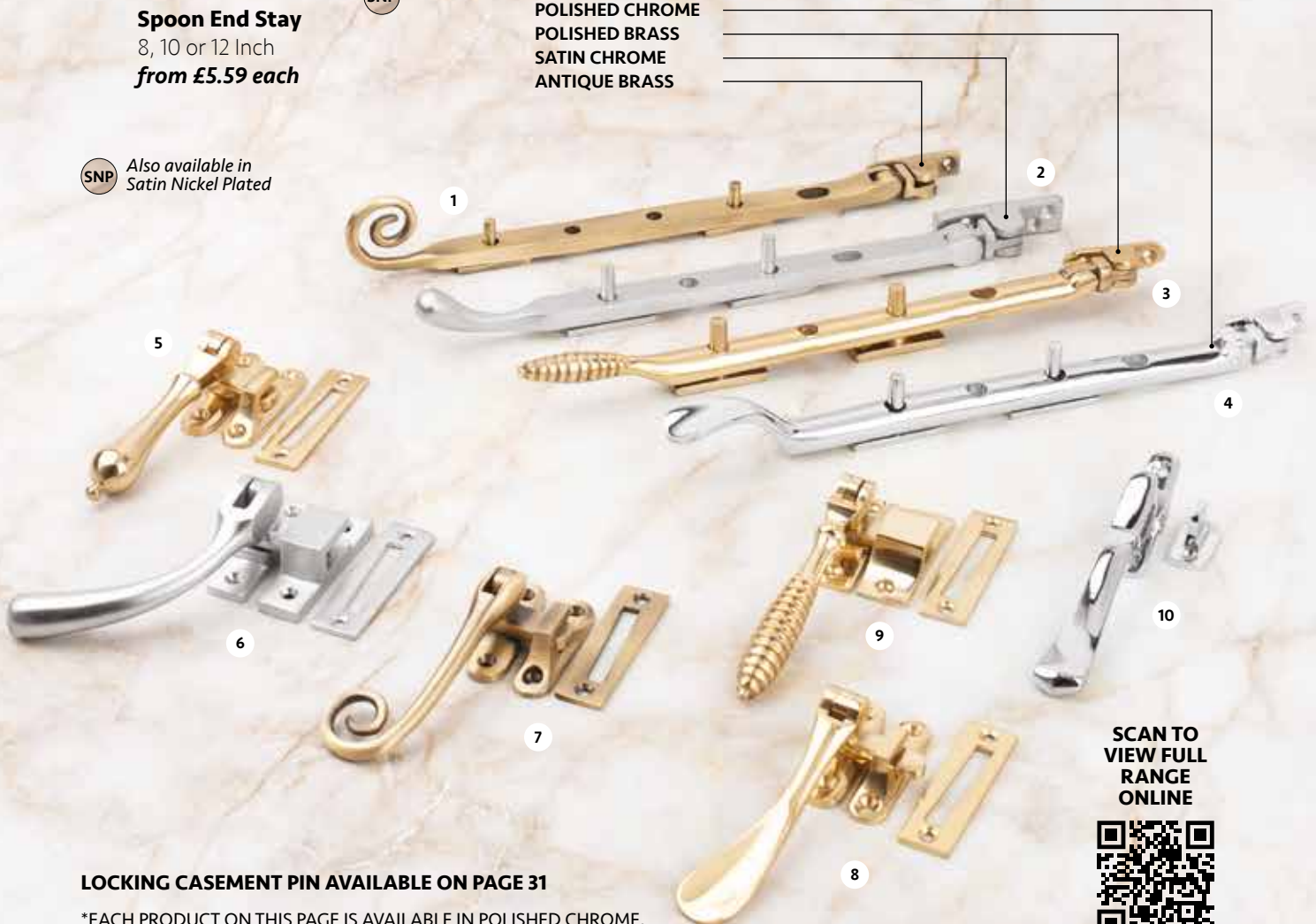

LOCKING CASEMENT PIN AVAILABLE ON PAGE 31

\*EACH PRODUCT ON THIS PAGE IS AVAILABLE IN POLISHED CHROME, POLISHED BRASS, SATIN CHROME & ANTIQUÉ BRASS. WHERE STATED SATIN NICKEL PLATED IS ALSO AVAILABLE.

SCAN TO  
VIEW FULL  
RANGE  
ONLINE



# DART

BRASS COLLECTION



11



12

Our **NEW** Dart Knurled range boasts a simple yet elegant design tailored for traditional casement windows. What sets them apart is the contemporary twist of the knurled pattern, a popular current design trend.

11

**DAR-118**

**Knurled Casement Fastener**  
with hook & Mortice Plate  
*from £6.58 each*

12

**DAR-118-8/10/12**

**Knurled Casement Stay**  
8, 10 or 12 Inch  
*from £6.74 each*

\*EACH PRODUCT ABOVE IS AVAILABLE IN POLISHED CHROME, POLISHED BRASS, SATIN CHROME, ANTIQUE BRASS & SATIN NICKEL PLATED.

## DOOR FURNITURE COMING SOON...

DART  
BRASS COLLECTION

Introducing our **NEW** range of traditional solid brass door furniture and accessories. All products available in the 4 finishes below.



POLISHED BRASS



POLISHED CHROME



SATIN NICKEL



ANTIQUÉ BRASS



# Heritage Brass

M. Marcus's signature brand, Heritage Brass, is renowned for exquisitely designed high quality products spanning door hardware, cabinet hardware, and electrical accessories. From conception to the current day, Heritage Brass continues to expand its ranges with timeless designs and extraordinary finishes to provide customers with ultimate choice and flexibility. Heritage Brass products provide a final touch of elegance to any interior.

**HERV990-8/10/12**  
**Spoon End**  
**Non-Locking Stays**  
 Available in 8", 10" & 12"

STANDARD FINISH	PREMIUM FINISH
8" from <b>£11.22</b>	8" from <b>£13.32</b>
10" from <b>£11.05</b>	10" from <b>£13.41</b>
12" from <b>£14.30</b>	12" from <b>£16.47</b>

**HERV992-8/10/12**  
**Bulb End**  
**Non-Locking Stays**  
 Available in 8", 10" & 12"

STANDARD FINISH	PREMIUM FINISH
8" from <b>£11.22</b>	8" from <b>£13.83</b>
10" from <b>£13.10</b>	10" from <b>£15.84</b>
12" from <b>£16.93</b>	12" from <b>£20.14</b>

**MATCHING DOOR HANDLES AVAILABLE**  
 SCAN TO VIEW ONLINE



**HERV1005W**  
**Heritage Spoon End**  
**Locking Fastener**  
 Weather Stripped Version

Allen key locking

STANDARD FINISH	PREMIUM FINISH
from <b>£17.47</b>	from <b>£22.09</b>

**HERV1008**  
**Heritage Ball End**  
**Non-Locking Fastener**

Suitable for weather strip windows

STANDARD FINISH	PREMIUM FINISH
from <b>£14.30</b>	from <b>£17.25</b>

**HERV1003**  
**Heritage Spoon End**  
**Non-Locking Fastener**

STANDARD FINISH	PREMIUM FINISH
from <b>£11.94</b>	from <b>£14.91</b>

POLISHED BRASS



POLISHED CHROME



SATIN CHROME



STANDARD FINISHES

SATIN NICKEL



POLISHED NICKEL



ANTIQUÉ BRASS



MATT BRONZE



SATIN BRASS



PREMIUM FINISHES

## Locking Casement Pin

- To suit above stays
- Complete with screws and key
- Available in Polished Brass, Polished Chrome and Satin Chrome



DAR-LP

**£11.90**  
ex VAT

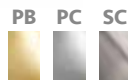

DART  
BRASS COLLECTION

## Fan Light Catch

- Flush and offset keep
- Complete with screws
- Available in Polished Brass, Polished Chrome, Satin Chrome and Antique Brass



SHC236  
from

**£7.59**  
ex VAT



DART  
BRASS COLLECTION

## Dart Roller Arm Stays

- Sizes available: 152mm or 200mm
- Height of Product: 30mm
- Complete with screws
- Non-Handed product
- Available in Antique Brass, Polished Brass, Polished Chrome, or Satin Chrome



152mm  
SHC250  
from

**£6.07**  
each

200mm  
SHC234  
from

**£7.04**  
each

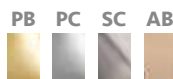

DART  
BRASS COLLECTION

## Dart Quadrant Arm Stays

- Complete with screws and key
- Available in Polished Brass, Polished Chrome, Satin Chrome and Antique Brass



152mm  
SHC235  
from

**£7.47**  
each

200mm  
SHC251  
from

**£10.08**  
each



DART  
BRASS COLLECTION

## Surface Fix Timber Pivot Hinge (Pair)

- This pair of timber pivot hinges have a simple surface mount design, and are suitable for timber windows up to 1.5 metres
- Available in Polished Brass, Polished Chrome or Satin Chrome



PIVOT

**£30.74**  
ex VAT

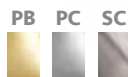

## Dart Concealed Pivot Window Hinge

- Manufactured from solid brass
- Easy installation
- Concealed fixing
- 2 pins and 2 receivers per pack



DAR-BWP-BR

**£11.33**  
ex VAT

DART  
BRASS COLLECTION

A LEADING  
SUPPLIER OF  
WINDOW & DOOR  
HARDWARE TO THE  
JOINERY INDUSTRY

ORDER BY **PHONE**, **EMAIL** or **WEB**



**01752 651330**



**sales@sdhardware.co.uk**



**www.sdhardware.co.uk**

**SD Hardware Ltd** | Unit 7 Forge Lane, Enterprise Park, Saltash, Cornwall PL12 6LX  
**Phone:** 01752 651330 **Fax:** 01752 253823 **Email:** sales@sdhardware.co.uk