

SAVE TIME AND MONEY USING EXTERNAL DOOR BLANKS



[O]E
DOORS & PANELS



**SASH + DOOR
HARDWARE**

So why use External Door Blanks?

It's simple really... you'll save time and money!

With timber prices rising, the production of doors is becoming more and more expensive. By using one of our Aben-dør (danish for open-door) door blanks, not only will you save on material costs you'll also save on production time and cost.

The great thing about using these particular door blanks, is not only is it more cost effective, you'll actually end up with a more stable and thermally efficient door than a solid timber door.

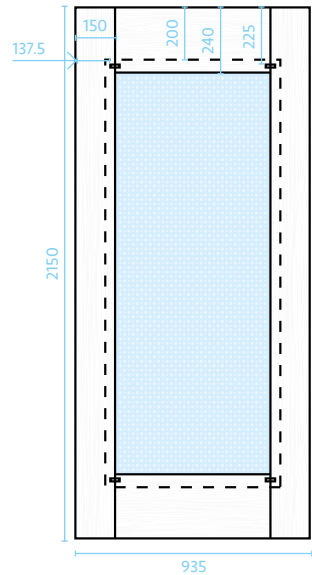

BENEFITS

- Exterior use
- 58mm Thick
- Secure By Design
- 6mm Veneer face (Chen Chen) which can be "V" Grooved
- 0.3mm Aluminium sheet front and back for stability and moisture barrier
- U Value of 1.28 w/m²K
- Insulated core with 2x4mm plywood that adds strength and stability
- Stiles of 150mm Pine
- Rails 240 mm (top/bottom)
- Weight 32kg

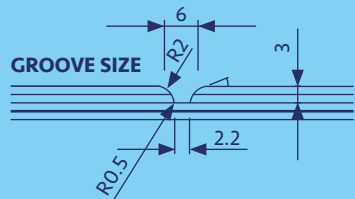

We stock 935mm x 2150mm doors which can be cut down to 715mm x 1750mm

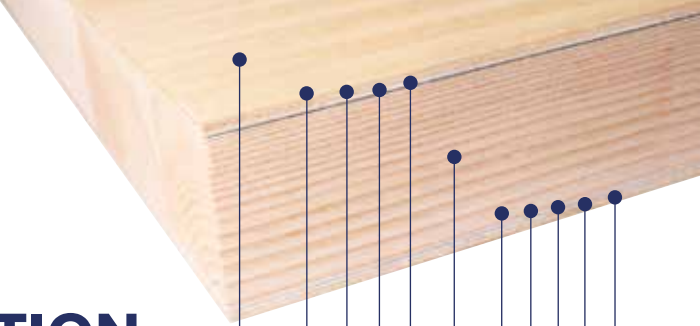

CONSTRUCTION

- 1.5mm Chen-Chen veneer
- 1.5mm cross grain veneer
- 1.5mm long grain veneer
- 0.3mm Aluminium - moisture barrier - stabilizer
- 1.5mm long grain veneer
- Insulation - Polystyrene/2 x 4mm plywood
- 1.5mm long grain veneer
- 0.3mm Aluminium - moisture barrier - stabilizer
- 1.5mm long grain veneer
- 1.5mm cross grain veneer
- 1.5mm Chen-Chen veneer

PROCESS

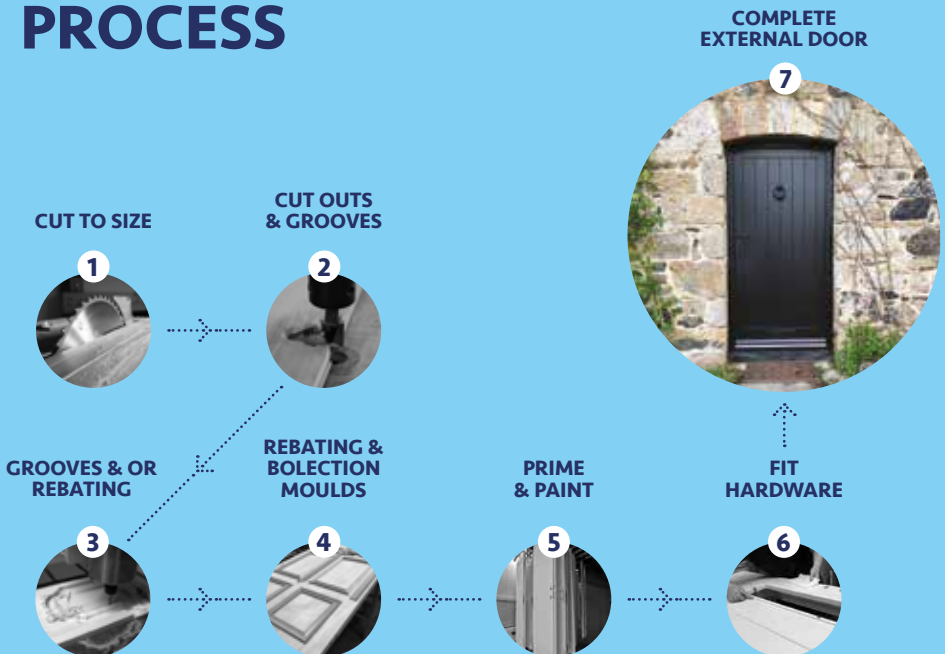

WHAT OUR CUSTOMERS HAVE TO SAY ABOUT USING EXTERNAL DOOR BLANKS



Kieran O'Connor
TRADEZONE WINDOWS



The OH Door Blank is an effective alternative to the traditional doors process and allows us to produce bespoke and modern designs for our customers.

The veneer face allows us the flexibility to V-Groove any design our customers requires.

The Aluminium Sheets and Insulated Core adds both strength and stability that we require in our front doors.

Once processed through our workshop and finished they create stunning doors.



Tom Buckler
JTP JOINERY



At JTP Joinery we've been using Aben-dør door blanks for over 2 years with great success. They are versatile, adaptable and most importantly stable and secure. The vast majority of our joinery is factory sprayed meaning we rely heavily on all materials taking a spray finish well, the Aben-dør door blank ticks all the boxes in this department. Overall a fantastic product at an affordable price.



Clive Morris
C&K JOINERY



These external door blanks are a great alternative to manufacturing our own timber doors. The various reasons being, escalating costs of timber, less production processes and being able to produce a more stable door, due to the aluminium sheets and insulation. They enable us to manufacture beautiful doors at competitive prices.





**SASH + DOOR
HARDWARE**

Aben-dør Door Blanks are distributed throughout the UK by SD Hardware Ltd

Unit 7 Forge Lane, Enterprise Park, Saltash, Cornwall, PL12 6LX

Call now on 01752 651330

or email: sales@sdhardware.co.uk

www.sdhardware.co.uk