

Timber composite decorative moulding
for use on both exterior and interior door panels.

Required Profile:
QW-DBM1

Door Bolection Moulding

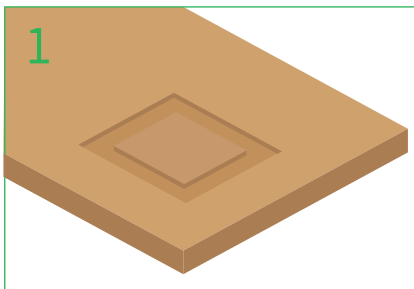
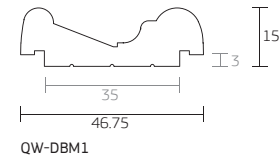

Machine grooves into door panel to accept bolection moulding (QW-DBM1) to a minimum depth of 3mm and a width of 35mm taking care not to break through the panel core insulation.

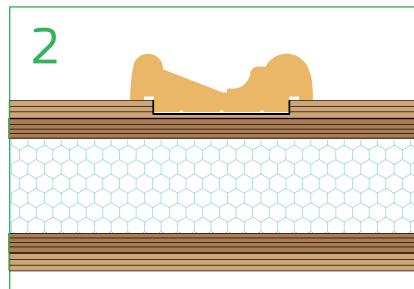

Use a short piece of bolection mould to check depth and width.

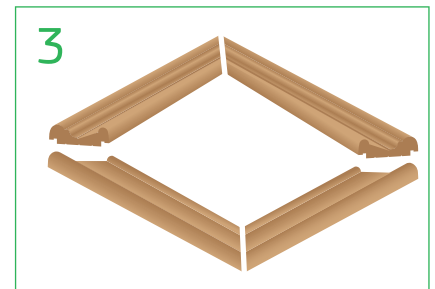

Measure and mitre cut the bolection to suit the panel cut out.



Ensure the correct orientation of the bolection as shown above.

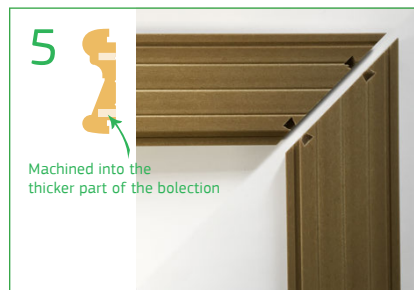

Machine butterfly/dove tail grooves.



Join the pieces with butterfly joints to create the full cassette.

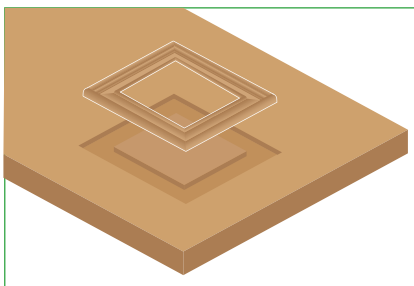

Apply high strength, waterproof timber adhesive to door groove and/or base of cassette, subject to adhesive manufacturers recommendations. Assemble cassette into door groove, apply pressure and allow to cure. Use panel pin fixings for added security.

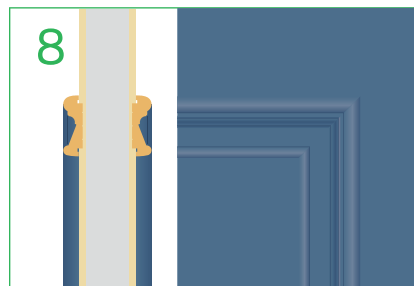

Remove excess adhesive and prepare for paint. Apply paint finish to the paint manufacturers recommendations.

If you require any further information or assistance with the fitting of any Qwood product, please contact us:
+44 (0) 161 627 4222
info@qwood.co.uk
www.qwood.co.uk